

2024

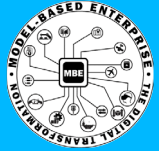

Model Based Enterprise

Summit

Hybrid Standards and Ad-hoc Approach to Balance Near Term Needs with a Long Term Information Assurance Vision

Ben Kassel

Visiting Principal Faculty Specialist

bkassel@arlis.umd.edu

301 226 8873



APPLIED RESEARCH LABORATORY FOR
**INTELLIGENCE
AND SECURITY**



2024

Our entire manufacturing future is the vision of Bradbury, Asimov, Clark, and Roddenberry

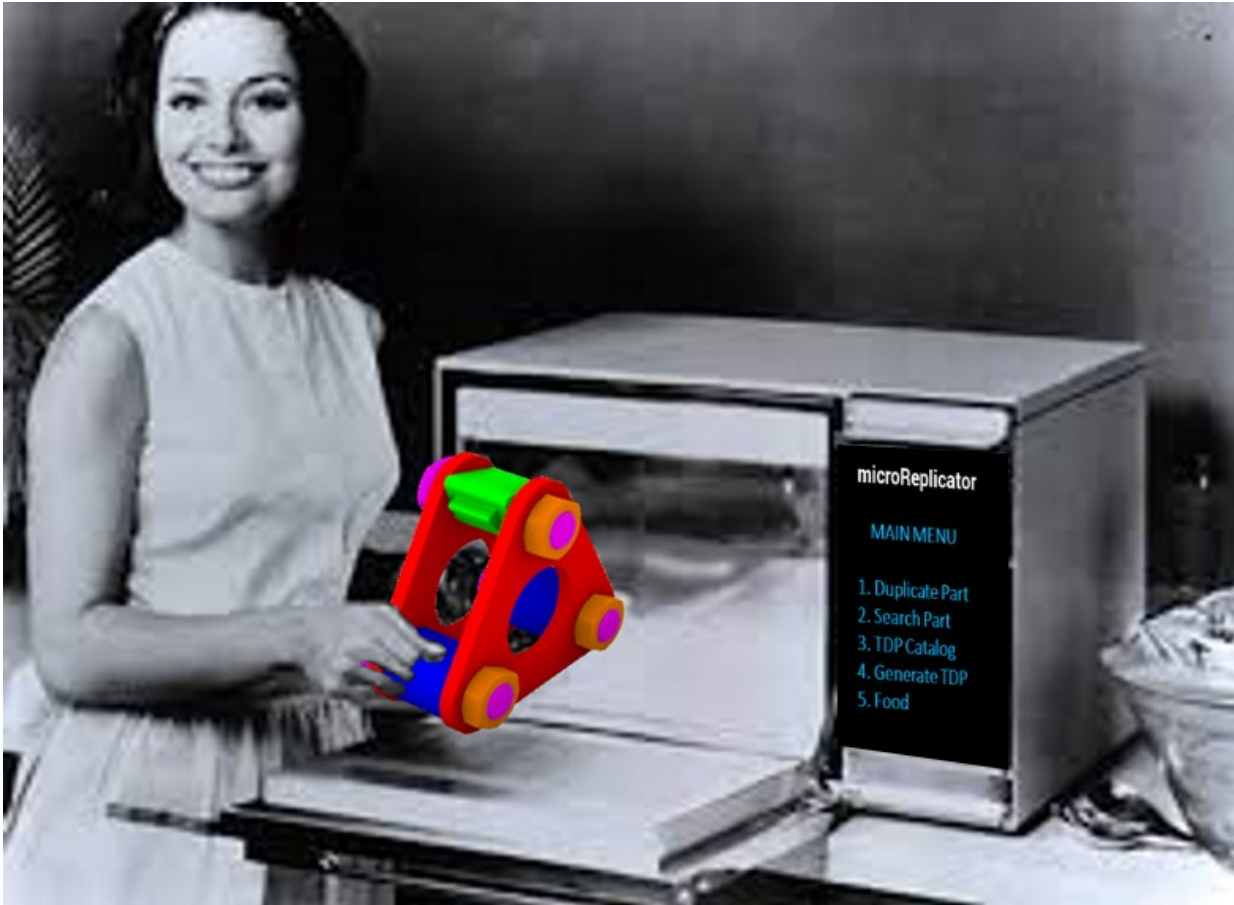

Model Based Enterprise

Summit



Our entire manufacturing future is the vision of Bradbury, Asimov, Clark, and Roddenberry



Model Based Enterprise

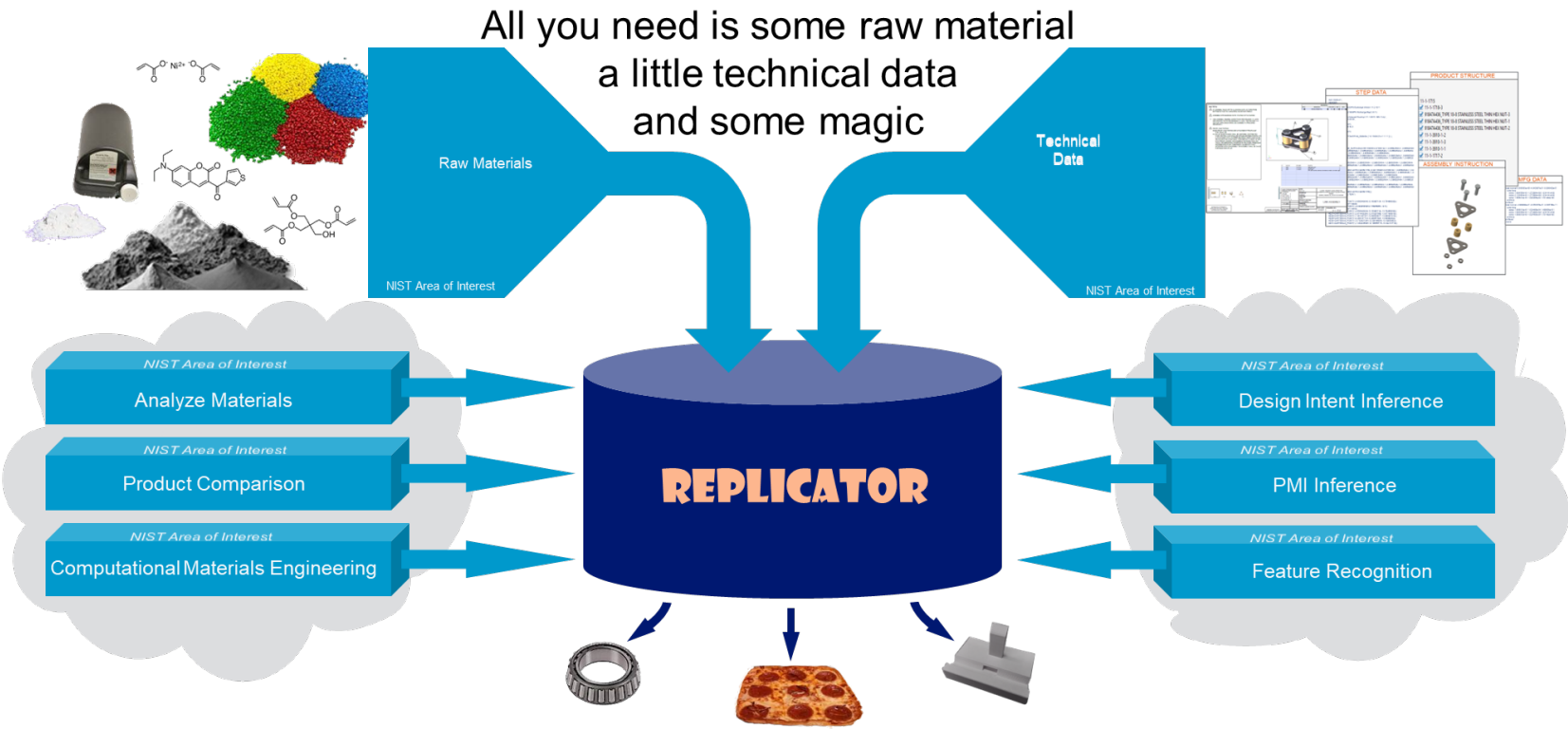

Standards Based Digital Thread and Long Term Archive Framework

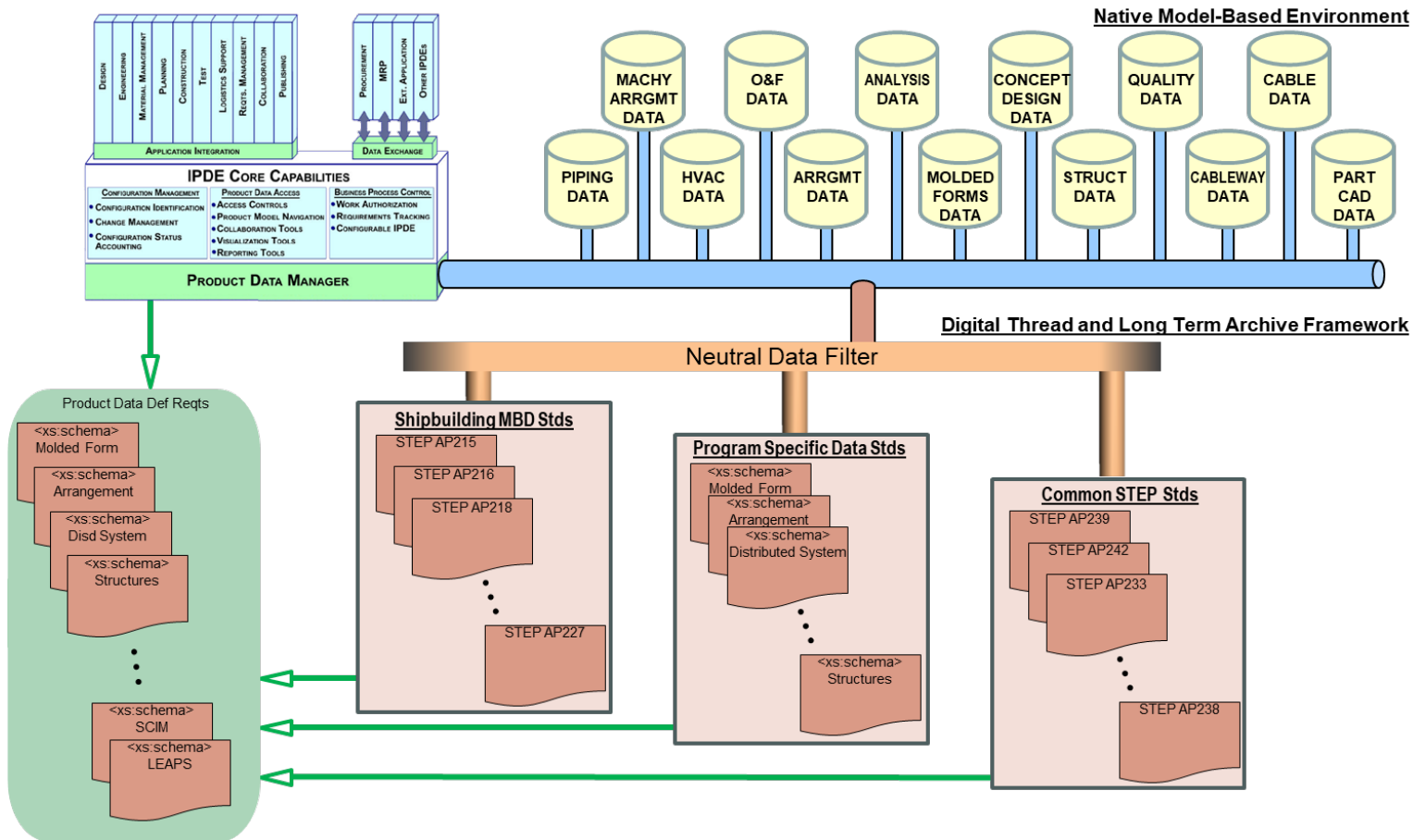
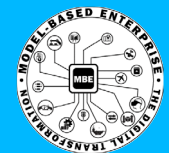

Standards Based Digital Thread and Long Term Archive Framework

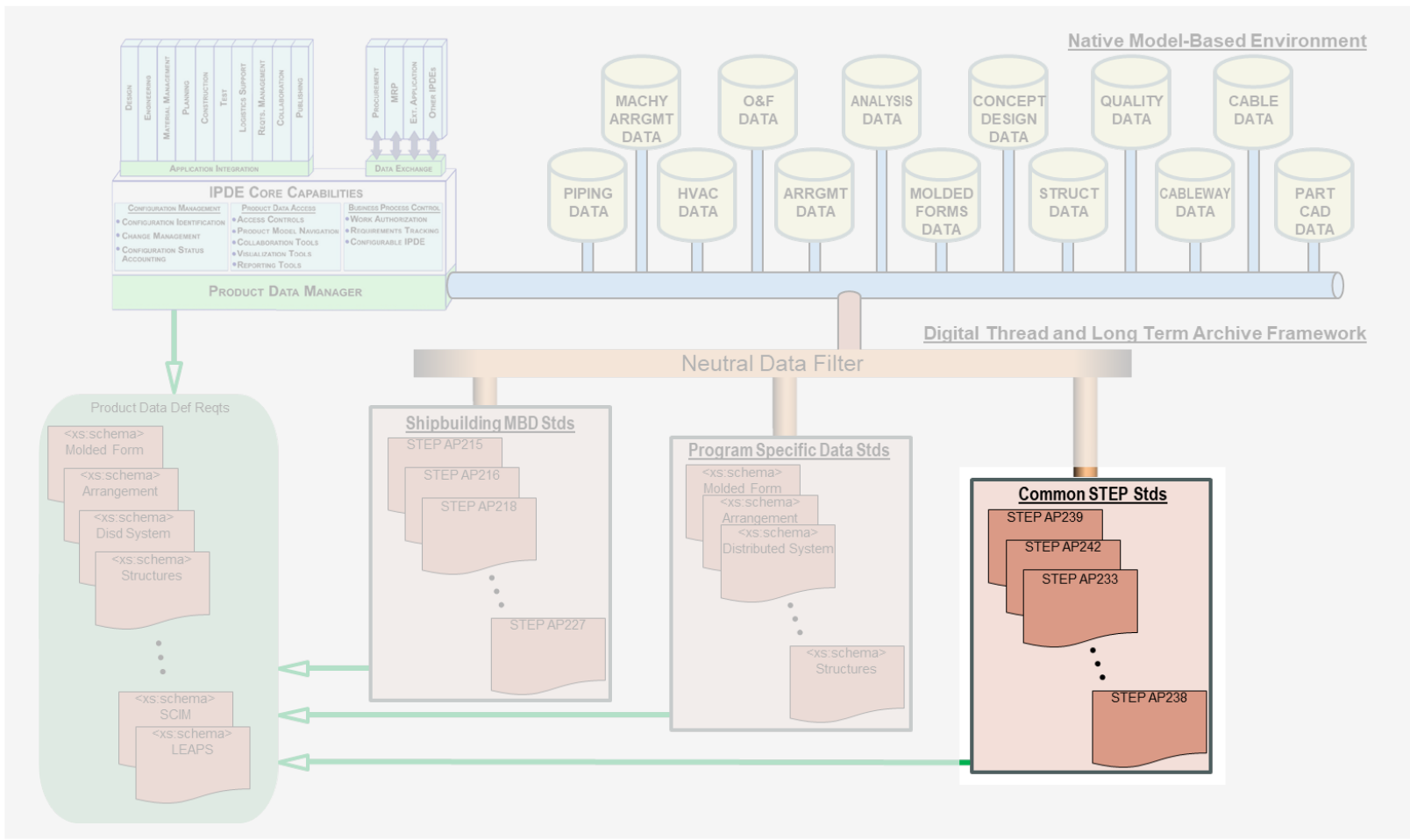
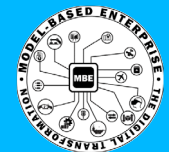

Standards Based Digital Thread and Long Term Archive Framework

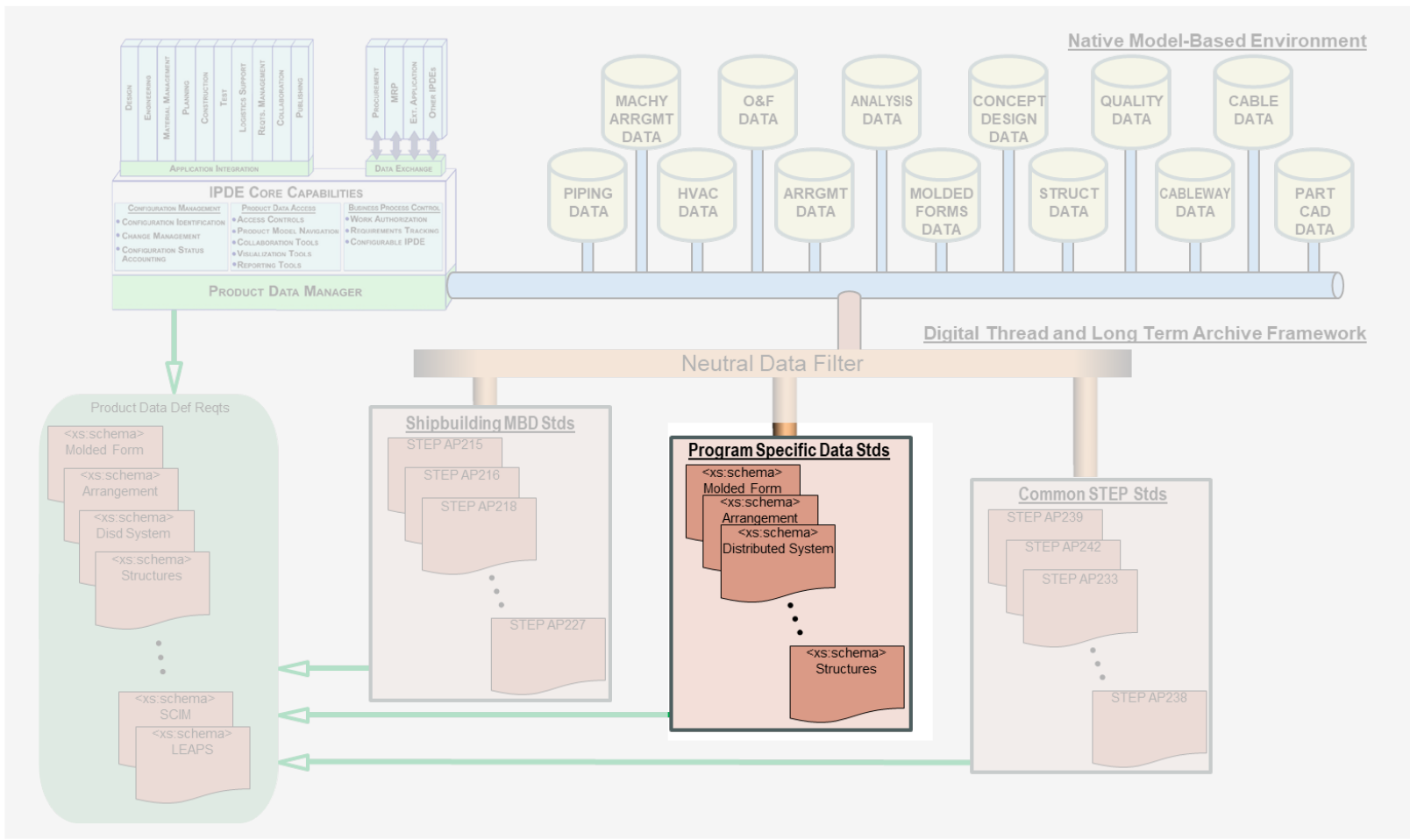

Standards Based Digital Thread and Long Term Archive Framework

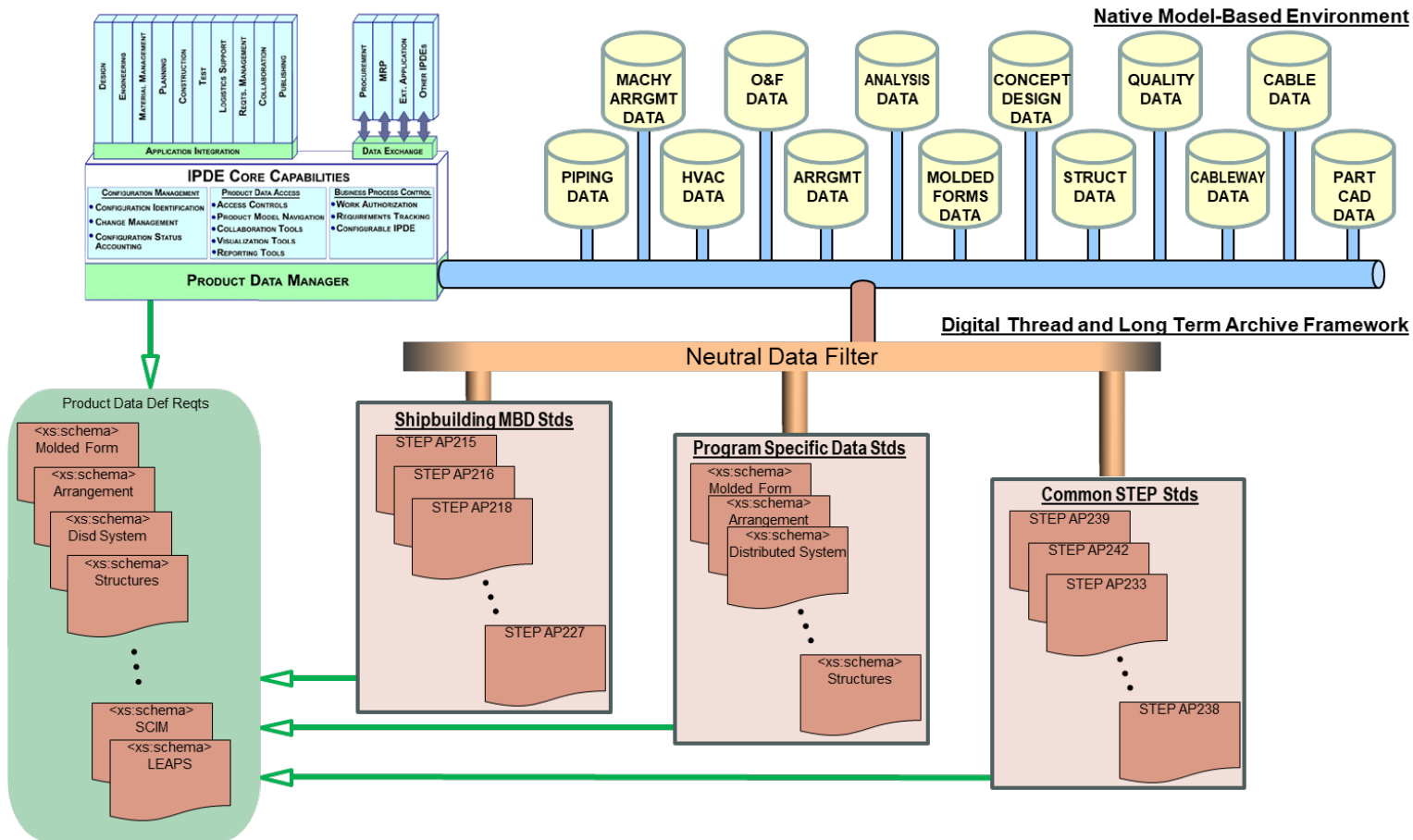
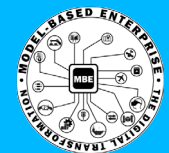

2024



Model Based Enterprise

Summit

Welcome to my highly Integrated Digital Thread Enabled Model-Based Environment



2024

Silos Exist

Fact of Life



Model Based Enterprise

Summit



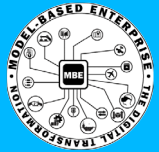

That was a mouthful

Now tell me what it means

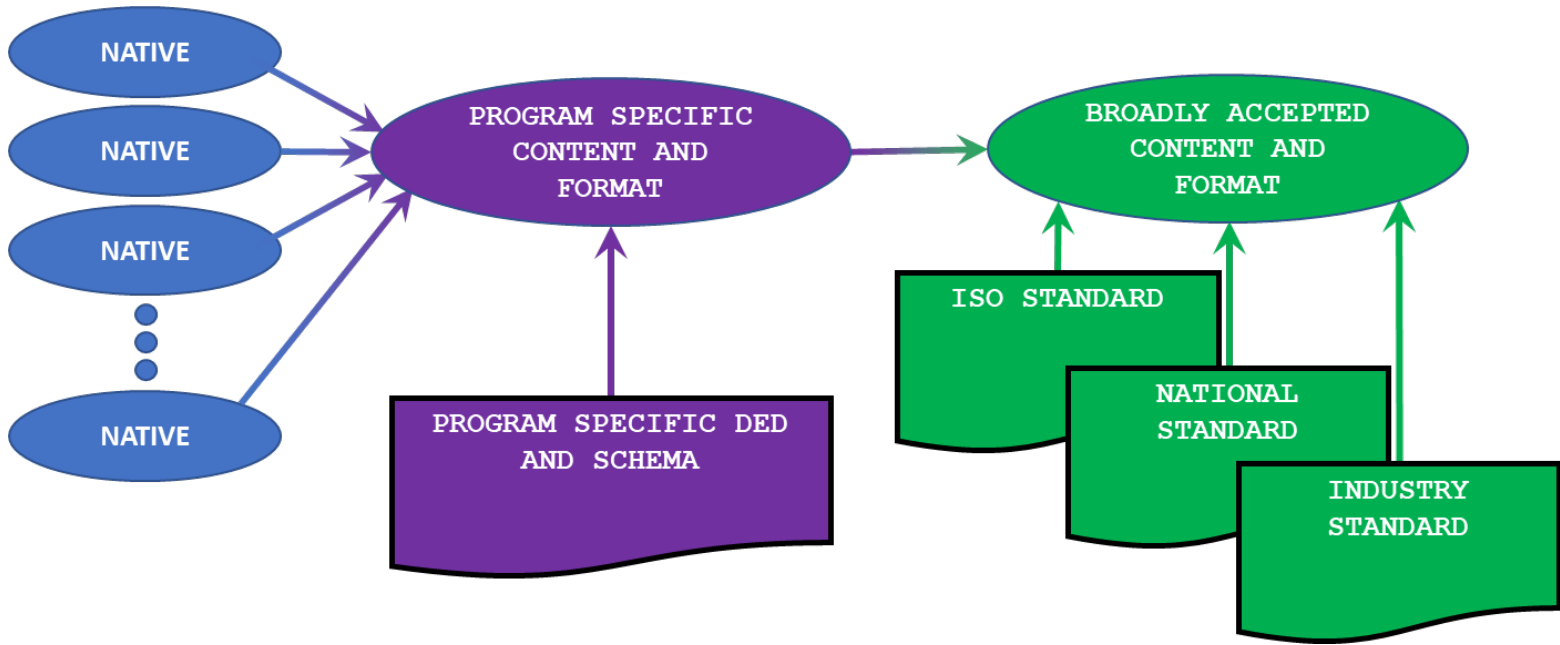

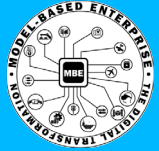
**Part & System Definition**

- Caterpillar 3512
- Starboard Main Engine
- Propulsion System

Design Definition

- 12 cylinder
- 4 stroke
- Diesel engine

Physical

- Geometry
- Material connection

Engineering Definition

- 1175 HP
- 6464kg
- 170mm bore
- 190mm stroke

Process Definition

- Starting instructions
- shaft alignment

Logistics Support

- FGC
- SCLSS

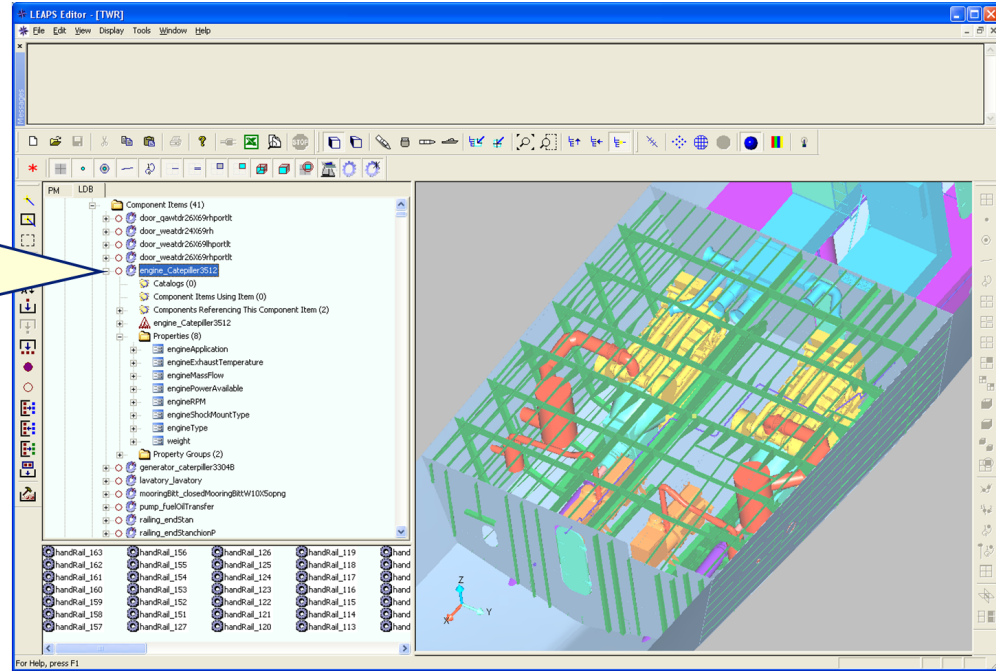

But what about other stuff?



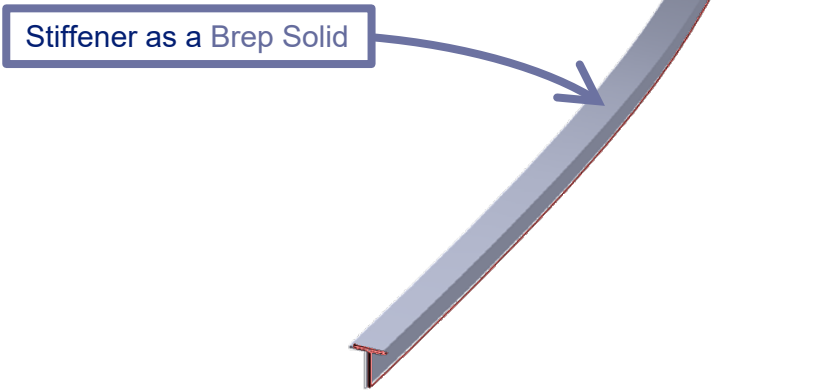
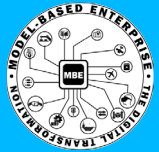



Stiffener as a parametric cross section and a trace

```
Entity name="npd:Profile_functional_definition" module="AP218"  
  Entity name="npd:W_shape_cross_section" module="AP218"  
    enumeration value="stiffener"  
    Property name="Depth"  
    Property name="Flange_thk"  
    Property name="K"  
    Property name="Radius"  
    Property name="Web_thk"  
    Property name="Width"  
  Entity name="npd:Section_properties" module="AP218"  
    Property name="Area"  
    Property name="Moi_u"  
    Property name="Moi_uv"  
    Property name="Moi_v"  
    Property name="Na_u"  
    Property name="Na_v"  
    Property name="Nominal_mass_per_len"  
    Property name="Tr"  
  Entity name="npd:Profile_curve_trace_line" module="AP218"  
    Entity_ref eref="geometry_schema:curve"  
  module="geometry_schema"
```

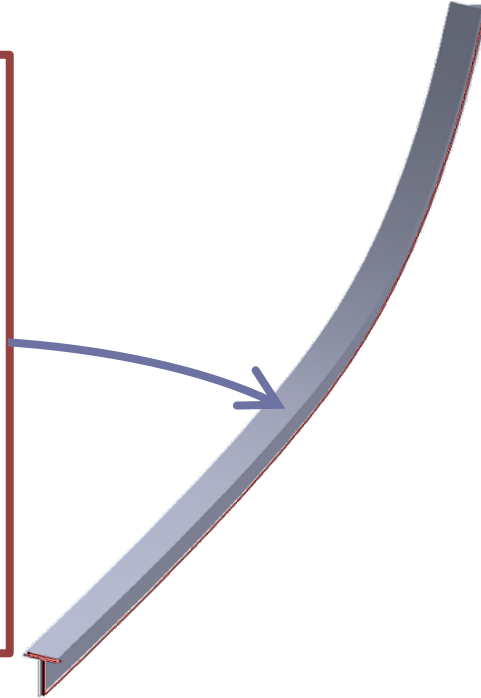

Sometimes my shape may seem a bit strange

But it is the shape I need

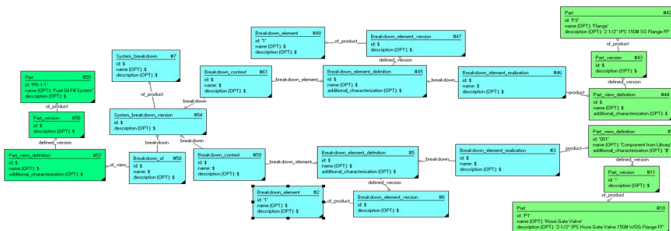

```

/* Fuel Oil Fill System Definition */
#58 = BREAKDOWN_OF($,$,$,#54,#57);
#54 = SYSTEM_BREAKDOWN_VERSION($,$,#7);
#7 = SYSTEM_BREAKDOWN($,$,$);
/* Hose Gate Valve as member of Fuel Oil Fill System */
#59 = BREAKDOWN_CONTEXT($,$,$,#54,#5);
#5 = BREAKDOWN_ELEMENT_DEFINITION($,$,$,$,(),#6);
#6 = BREAKDOWN_ELEMENT_VERSION($,$,#2);
#2 = BREAKDOWN_ELEMENT('1',$,$);
#3 = BREAKDOWN_ELEMENT_REALIZATION($,$,$,#5,#12);
/* Flange as member of Fuel Oil Fill System */
#61 = BREAKDOWN_CONTEXT($,$,$,#54,#45);
#45 = BREAKDOWN_ELEMENT_DEFINITION($,$,$,$,(),#47);
#47 = BREAKDOWN_ELEMENT_VERSION($,$,#48);
#48 = BREAKDOWN_ELEMENT('1',$,$);
#46 = BREAKDOWN_ELEMENT_REALIZATION($,$,$,#45,#44);
/* Connection between hose gate valve and flange */
#66 = INTERFACE_CONNECTION($,$,'bolted',#63,#64);
#65 = INTERFACE_CONNECTOR_DEFINITION($,$,$,'1/8" gasket,
4 - 3/8 - 16UNC" x 2" bolt',$,$,(),$,$);
#64 = INTERFACE_CONNECTOR_OCCURRENCE($,$,$,#65,#44);
#63 = INTERFACE_CONNECTOR_OCCURRENCE($,$,$,#65,#12);
ENDSEC;
END-ISO-10303-21;
  
```

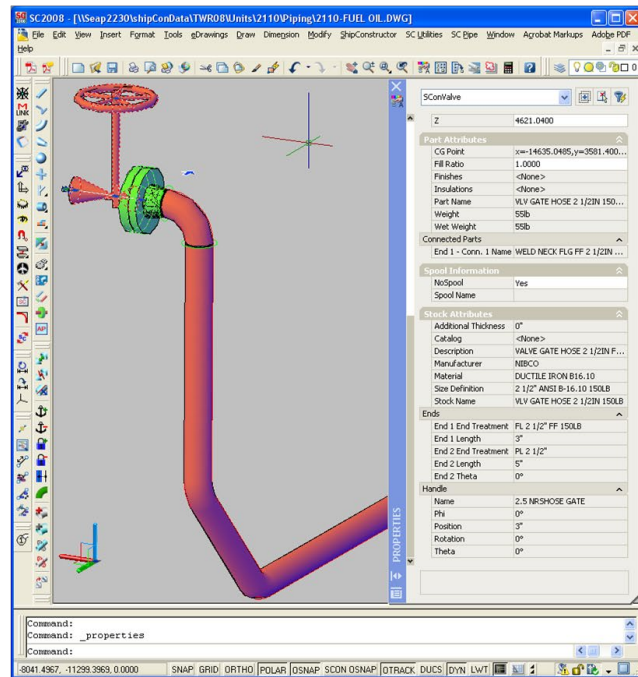

But what about other stuff?



Shape Data and PMI is important

... but product data is so much more

Shape
Product Information
Manufacturing Information

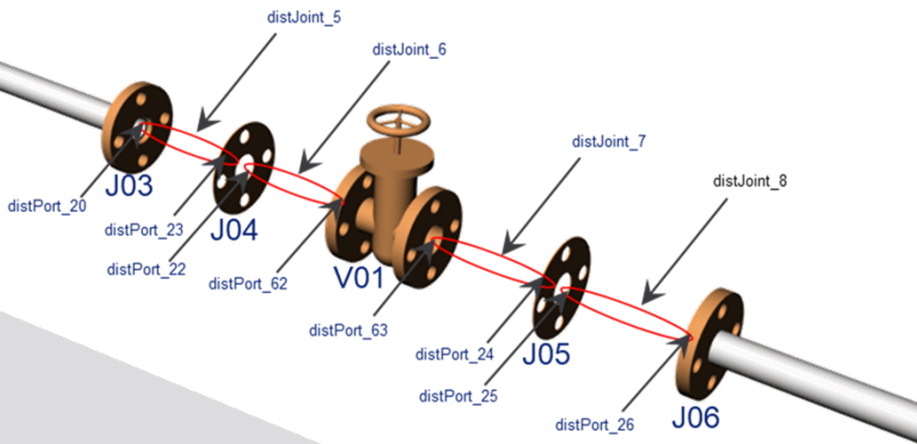
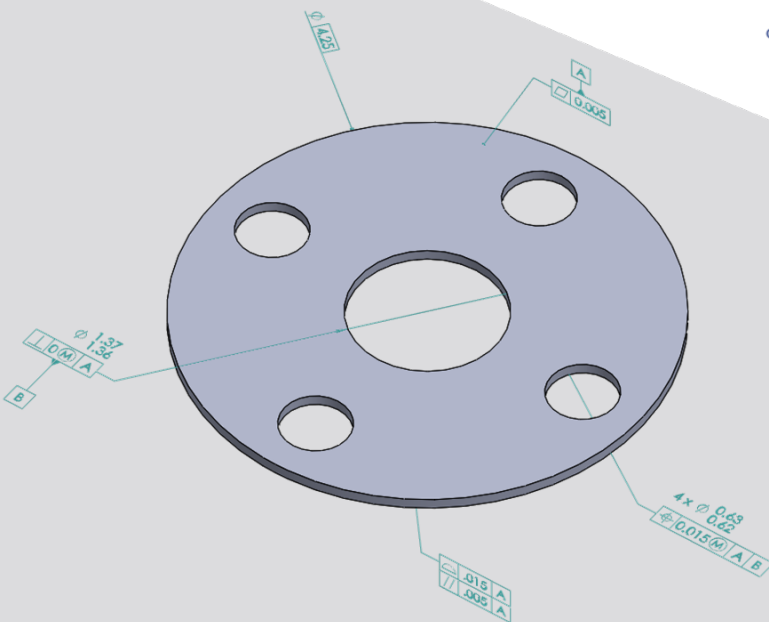

Functional Definition
Systems Engineering
Simulation and Analysis
Configuration Control

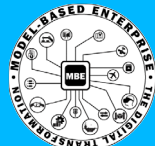

2024

Casting



Model Based Enterprise

Summit



2024

Robotics and Assembly



Model Based Enterprise

Summit



2024

Nesting and Cutting



Model Based Enterprise

Summit



2024

Pipe Bending



Model Based Enterprise

Summit



2024

Welding



Model Based Enterprise

Summit



2024

my fave, good old fashioned material removal

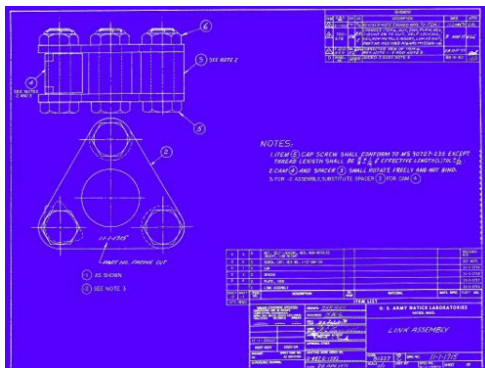
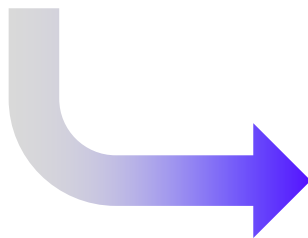
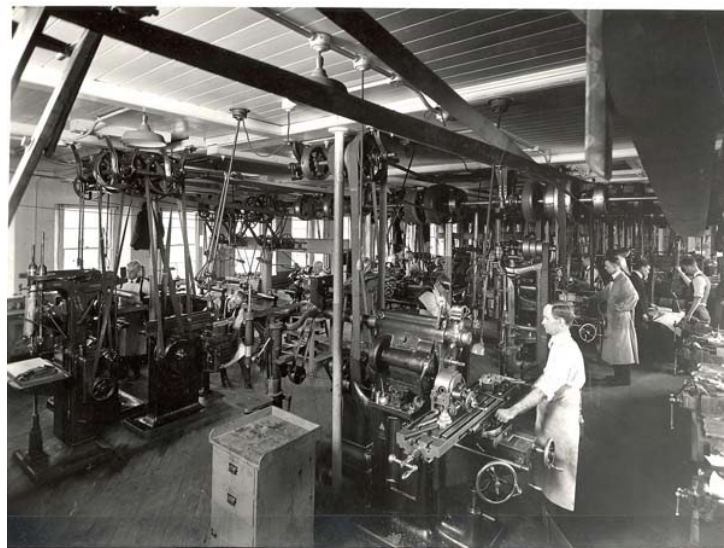

Model Based Enterprise

Summit



2024

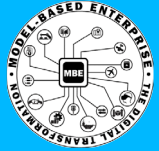

Model Based Enterprise

Hybrid Standards and Ad-hoc Approach to Balance Near Term Needs with a Long Term Information Assurance Vision

Ben Kassel

Visiting Principal Faculty Specialist

bkassel@arlis.umd.edu

301 226 8873



APPLIED RESEARCH LABORATORY FOR
**INTELLIGENCE
AND SECURITY**



Summit