

# NIST

National Institute of Standards and Technology  
U.S. Department of Commerce

SPONSORED BY THE  
Science and Technology Directorate  
U.S. Department of Homeland Security  
RobotTestMethods.nist.gov

## 4" Obstructed Lane aka Confined Lane (3.5" stickers for quart sized tubs)

This file is split into 2 parts.

Pages 1 and 2: Stickers for pre-assembly of landing pads and the outer sides of perpendicular buckets. These should read upright when the bucket is facing sideways.

Pages 3 and 4: Stickers to be applied after buckets are screwed down, and placed over the screws. See Page 3 for further instructions

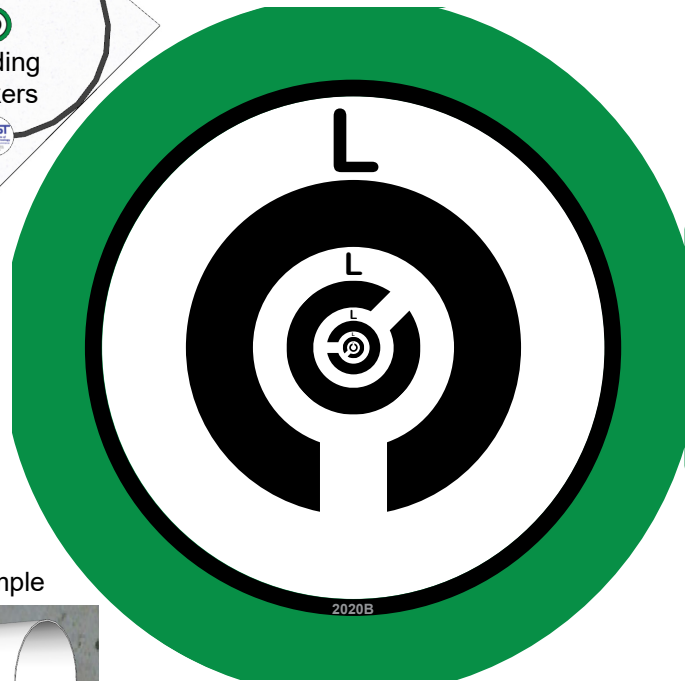
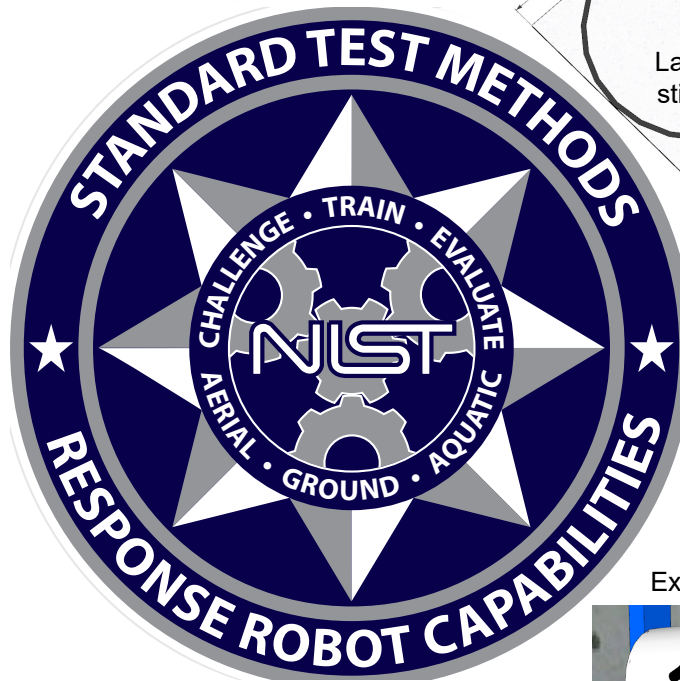

Example

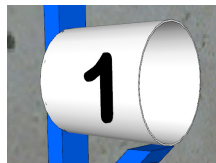



### 4" Obstructed Lane aka Confined Lane

(3.5" stickers for quart sized tubs)

Stickers to be applied after buckets have been screwed down.

Stickers should be applied over the screws as follows.

**Buckets 1 and 1A**  
Initial Assembly:

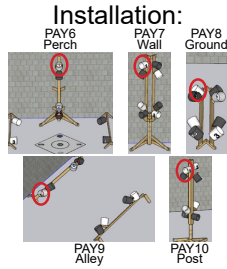
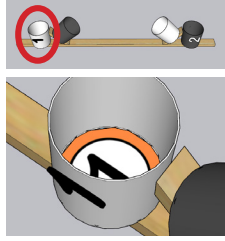

Initial Assembly:

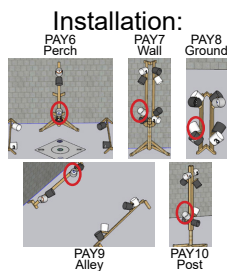

**Buckets 2 and 2A**  
Initial Assembly:

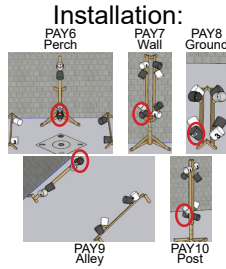
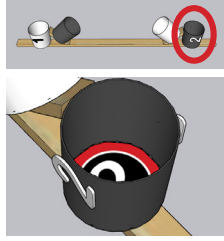

Initial Assembly:

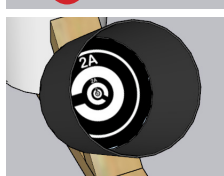

**Buckets 3 and 3A**  
Initial Assembly:

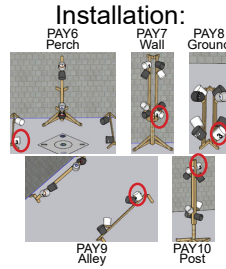
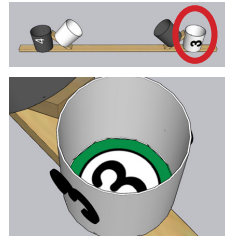

Initial Assembly:

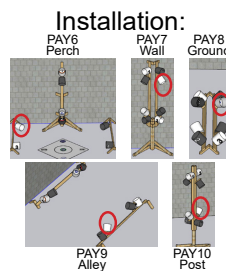

**Buckets 4 and 4A**  
Initial Assembly:

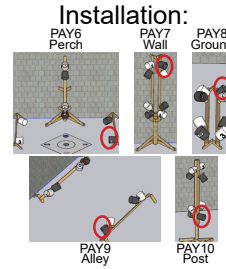
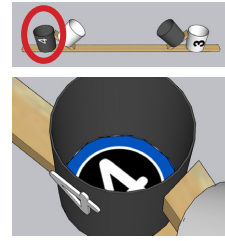

Initial Assembly:

